

## G100 Alloy Steel Omega Link

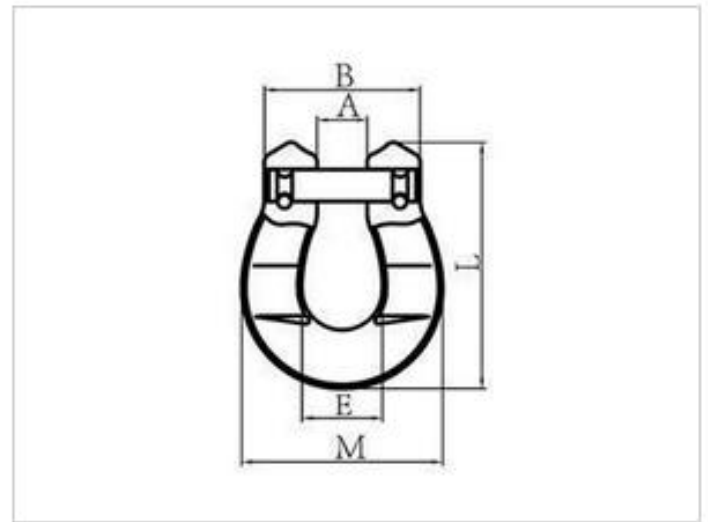

### Features

- It is forged by special alloy steel with high intensity and high toughness, and then it is heat treated;
- It can be matched with G100 chains;
- The performance is increased by 25% compared with G80 products;
- Each workpiece should pass testing at 2.5 times of working load limit;
- We should carry out sampling and 20000 times of fatigue testing;
- We should carry out strict sampling and breakage testing for each batch of products;
- We should carry out 100% magnetic powder flaw detection;
- 100% of the pin should be tested to ensure that they have the same hardness;
- Surface treatment: powder plastified;
- Color code: Blue RAL5015.

### Parameters (Unit: mm)

Item code	Weight (kg)	Working load limit (t)	Breaking load (t)	A $\pm$ 0.5	B $\pm$ 2	E $\pm$ 1.5	M $\pm$ 2	L $\pm$ 2
10-SLR1027-06	0.12	1.4	5.6	8.5	32.5	20	44	55
10-SLR1027-08	0.27	2.5	10	10.5	42	24	60	73.5
10-SLR1027-10	0.44	4	16	12.5	48.5	31	70	90
10-SLR1027-13	0.89	6.7	26.8	16	60	38.5	90	109
10-SLR1027-16	1.69	10	40	19	75.5	51	112	141.5

Ultimate load is 4 times the Working Load Limit.